



YZO-系列

振动电动机

SERIES YZO VIBRATOR MOTOR



上海强振电机设备有限公司
SHANGHAI QIANGZHEN MOTOR EQUIPMENTS CO., LTD.

公司简介及概况

上海强振电机设备有限公司是集科研、生产、销售、服务于一体的专业振动电机生产企业，经过10多年的发展，振动电机已经在人才、技术、市场、品牌诸多方面形成综合优势，电机生产销售总量逐年递增，由于质量稳定，产品先后被国内外各大钢铁厂的炼铁高炉、铸造机械及矿山机械相继选用，并批量出口各个国家和地区。多年来公司一直坚持“追求卓越”的企业宗旨和与“客户共谋发展”的经营理念，在经营中秉承真诚的态度，良好的信誉，卓越的品质和完善的服务，深受国内外用户的信赖。

公司拥有多台高精度数控车、铣、磨、钻床及加工中心等成套机加工设备，高素质的专业设计工程师及熟练的机加工操作人员。产品从设计、加工到装配成型，每一道工序都严格控制，精密检测，确保每个工件的加工精度；在装配完成以后，所有的成品都经过精密测试台检测，由专职检测员确认合格方可出厂。公司还可根据您的装配及使用参数等要求进行针对性设计生产，满足您的不同需求。我公司位于中国上海北部宝山区，相接于美丽的崇明岛。

本公司是中小型电机专业制造厂，为国内较早生产电机的厂家，振动电机系列产品按机电部标准 JB5330—2007《振动源三相异步电动机技术条件》设计制造，振动电机产品有 YZO YZS YZFD TZD ZDJ 各个系列的振动电机及其派生系列(如立式、调速型、防闭塞等)振动电机，在国家重点工程中有广泛的应用。

振动电机是各类振动机械的通用型激振源。可配套于振动给料机、振动筛、振动输送机、振动落砂机、振动放矿机、振动光饰处理机、振动干燥机和料仓振动防闭塞装置等。广泛应用于矿山、冶金、煤炭、电力、建材、机械、铸造、化工和轻工食品等行业。

Shanghai Qiangzhen Motor Equipment Co., Ltd. Was founded in 2006, Located in Baoshan District , Shanghai, near the beautiful island – Chongming Island.

Our company is focus on researching,Producing and saling of vibration motors. After about 10 years of development, our company is now having comprehensive advantages in personnels, techniques and services. Our products covers YZO/YZS/YZFD/TZD/ZDJ series of vibration motors , were designed against the standard of JB5330–2007 'Technical condition of three phase asynchronous motor for vibration source'.

With the total sales grew year by year, our products had been purchased by many famous Iron & Steel companies, home and abroad, applied in their blast furnace system, casting machine and mining system.

Our mission is 'excellence & collaboration'.

Our company had equiped numbers of CNC lathes, milling machines, grinding machines, drilling machines and machines ceters. All personnels were well trained before job. All products will be strictly controled during process of design and production. And all the products will be strictly tested before shipment. Our designing team can also revise our designation to fulfil your special requirements of prodution and application.

Vibrator motor is general vibration source for various vibrator machinery , such as vibrator feeder , vibrator conveyor,ore vibratory discharger,vibratory shakeout machine,vibrator sizer and stock-bin vibratory block–proof device . ect.It may be exten–sively used in various industries,such as power,constructional material,coal,mine,metallurgy,chemistry,light industry and foundry,etc.

YZO系列振动电机

Series YZO vibrator motor

型号表示方法 Meaning of symbol

例: For example

YZO — 20 — 4

YZO系列普通型振动电机

Series YZO vibrator motor



额定激振力 (20KN)

Rated vibration force(20KN)

极数(4极)

Number of pole(4pole)

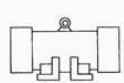
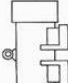
安装形式 INSTALLATION FORM

卧装 Horizontal	竖装 Vertocal	任意方向安装 Arbitrary angle
		

注: 规定激振力在20KN以上的振动电机、竖装和任意角度方向安装时, 应保证电机非出线盒端装在下侧

Notice:For the vibrator motor Which vibration force is larger then 20 KN.the motor end with no terminal box should be in lower when it installates in vertical or at arbitrary angle.

振动电机特点

The feature of vibrator motor



强 振

- 设计先进，激振力与出力配合适当，重量轻、体积小。
- 激振效率高。利用平稳回转产生振动，噪声低。
- 全封闭结构，可在任何无防爆要求的粉尘条件下工作（防爆型除外）
- 只需调节偏心块夹角，就可无级调整激振力。
- 可多机组合成各种振动形式，以完成各种作业要求。
- 规格齐全，能满足各类振动机械的工作需要。
- Advanced design,vibration force and output is matched properly.The motor is light in weight and small in size
- The efficiency is hig.Due to the vibration is produced by smoothly rotation,therefore the noise is low.
- Total enclosure structure,it can be operated under any dust conditions which have not explosin-proof requirement. (Except YBZO flameproof type)
- Just adjust the angle of centrifugal weight,the vibration force can be regulated steplessly.
- Various vibration forms can be combined by several motors.Every working requirement can be saitsfied.
- The specifcaitons are abundant.The working reirement of every vibratory mahinery can be satisfied.

振动电机使用条件

The operation condition of vibrator motor

电源电压频率: 380伏50赫兹或460伏60赫兹
绝缘等级: B或F
工作方式: 连续 (短频型除外)
环境温度: 不超过 40℃
海拔: 不超过 1000米

Power voltage and frequency: 380V,50Hz;460V,60Hz
Insulation class: B or F
Duty: continuous (Except YZDP type)
Ambient temperature: not exceed 40℃
Altitude: not exceed 1000m

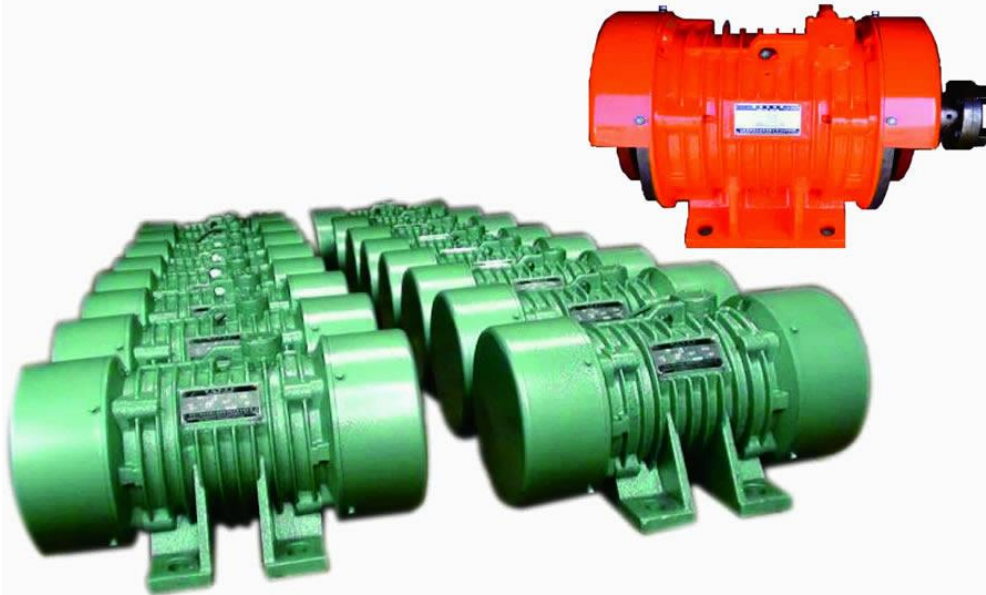

技术参数及安装尺寸

Technical Date and Installation Size

型号 Type	振次/分 Vibration number	额定 激振力 Vibration force(KN)	额定 功率 Power (kW)	额定 电流 Current (A)	外型图 代号 Picture NO.	安 装 尺 寸 Installation dimensions										安装 螺栓 尺寸 Boit	重量 Weight (Kg)
						A	B	H	AB	BB	HA	HD	L	CB	K		
YZO-1-2	2900	1	0.09	0.32	1	120	40	63	145	70	10	150	220	10	4*M8	9	
YZO-2-2		2	0.18	0.59	1	120	40	63	145	70	10	150	220	10	4*M8	10	
YZO-3-2		3	0.25	0.78	1	150	90	90	180	130	12	190	280	14	4*M12	20	
YZO-4-2		4	0.30	0.85	1	150	90	90	180	130	12	190	280	14	4*M12	22	
YZO-5-2		5	0.37	1.10	1	180	110	100	225	150	14	220	370	18	4*M16	26	
YZO-8-2		8	0.62	1.46	1	180	110	100	225	150	14	220	370	18	4*M16	28	
YZO-10-2A		10	0.75	1.96	2	190	210	100	240	260	16	240	370	22	4*M20	45	
YZO-10-2		10	0.75	1.96	3	220	140	120	270	200	16	250	465	22	4*M20	45	
YZO-20-2		20	1.50	3.66	3	260	150	140	320	220	18	300	520	26	4*M24	75	
YZO-25-2		25	2.00	4.85	3	260	150	140	320	220	18	300	520	26	4*M24	80	
YZO-30-2		30	2.20	5.12	4	310	170	160	380	240	20	330	630	33	4*M30	110	
YZO-40-2		40	3.00	6.85	4	310	170	160	380	240	20	330	630	33	4*M30	120	
YZO-50-2		50	3.70	8.43	4	350	220	180	430	310	30	400	660	39	4*M36	180	
YZO-65-2		65	4.50	10.58	4	350	220	180	430	310	30	400	660	39	4*M36	190	
YZO-80-2A		80	5.50	13.88	4	380	250	215	470	400	35	460	620	45	4*M42	260	
YZO-80-2B		80	5.50	13.88	7	360	120	215	430	370	35	415	610	29	6*M27	250	
YZO-90-2A		90	7.50	14.33	4	380	250	215	470	400	35	460	620	45	4*M42	320	
YZO-90-2B		90	7.50	14.33	7	360	120	215	430	370	35	415	610	29	6*M27	270	
YZO-100-2A		100	9.00	15.38	4	380	250	215	470	400	35	460	620	45	4*M42	330	
YZO-100-2B		100	9.00	15.38	7	360	120	215	430	370	35	415	610	29	6*M27	280	
YZO-130-2	130	12.00	22.35	4	440	280	240	520	400	40	520	780	45	4*M42	380		



图1 NO.1

图2 NO.2

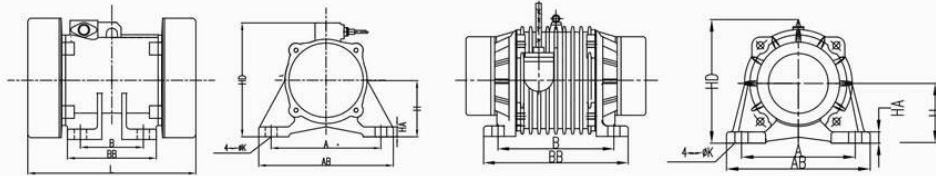

图3 NO.3

图4 NO.4

SHANGHAI QIANGZHEN MOTOR EQUIPMENTS CO., LTD.

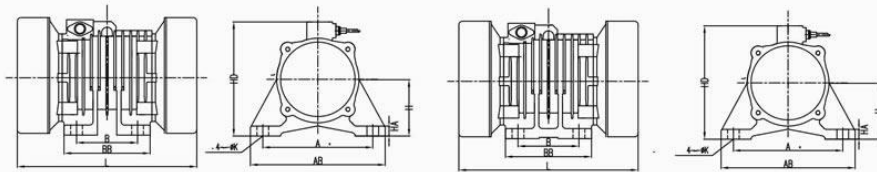

强 振

技术参数及安装尺寸

Technical Date and Installation Size

型 号 Type	振次/分 Vibration Number	额 定 激振力 Vibration force(KN)	额 定 功 率 Power (kW)	额 定 电 流 Current (A)	外型图 代 号 Picture NO.	安 装 尺 寸 Installation dimensions											安 装 螺 栓 尺 寸 Boit	重 量 Weight (Kg)
						A	B	H	AB	BB	HA	HD	L	CB	K			
						YZO-1-4	1	0.09	0.38	1	120	40	63	145	70	10		
YZO-2.5-4	2.5	0.12	0.47	1	150	90	90	180	130	12	190	280		14	4*M12	22		
YZO-4-4	4	0.20	0.75	1	150	90	90	180	130	12	190	280		14	4*M12	24		
YZO-5-4	5	0.25	0.87	1	180	110	100	225	150	14	220	370		18	4*M16	30		
YZO-8-4	8	0.37	1.18	3	220	140	120	270	200	16	250	465		18	4*M16	45		
YZO-10-4	10	0.55	1.76	3	220	140	120	270	200	16	250	465		22	4*M20	50		
YZO-13-4	13	0.65	2.05	3	220	140	120	270	200	16	250	465		22	4*M20	65		
YZO-16-4	16	0.75	2.17	3	260	150	140	320	220	20	300	465		26	4*M24	68		
YZO-17-4	17	0.85	2.2	3	240	140	130	305	215	20	300	465		26	4*M24	70		
YZO-20-4	20	1.10	3.18	3	260	150	140	320	220	18	300	520		26	4*M24	75		
YZO-25-4	25	1.35	3.35	3	260	150	140	320	220	18	300	520		26	4*M24	80		
YZO-30-4	30	1.50	3.8	4	310	170	160	380	240	20	330	630		33	4*M30	110		
YZO-40-4	40	1.85	4.52	4	310	170	160	380	240	20	330	630		33	4*M30	120		
YZO-50-4	50	2.20	5.57	4	350	220	180	430	310	30	400	660		39	4*M36	180		
YZO-63-4	63	3.00	7.2	4	350	220	180	430	310	30	400	660		39	4*M36	190		
YZO-80-4	80	3.70	8.9	4	380	250	215	470	400	35	460	670		45	4*M42	260		
YZO-90-4	90	5.50	12.38	4	380	250	215	470	400	35	460	670		45	4*M42	320		
YZO-100-4	100	6.30	14.25	4	440	280	240	520	400	40	520	780		45	4*M42	330		
YZO-130-4A	130	7.50	17.01	6	540	340	260	640	690	40	590	890	130	39	8*M36	645		
YZO-130-4	130	7.50	17.01	7	460	140	250	550	400	40	490	810	140	45	6*M42	590		
YZO-160-4A	160	10.00	22.68	6	540	340	260	640	690	40	590	890	130	39	8*M36	700		
YZO-160-4	160	10.00	22.68	7	460	140	250	550	400	40	490	810	140	45	6*M42	625		
YZO-180-4	180	12.00	27.68	8	600	120	270	690	510	45	550	950	120	45	8*M42	810		
YZO-210-4	210	16.00	31.5	8	600	120	270	690	510	45	550	970	120	45	8*M42	850		
YZO-250-4A	250	18.00	39.05	6	630	420	300	740	840	48	680	1060	160	45	8*M42	1150		
YZO-300-4A	300	22.00	47.66	6	630	420	300	740	840	48	680	1170	160	45	8*M42	1260		



技术参数及安装尺寸

Technical Date and Installation Size

型号 Type	振次/分 ibration Number	额定 激振力 Vibration force(KN)	额定 功率 Power (kW)	额定 电流 Current (A)	外型图 代号 Picture NO.	安 装 尺 寸 Installation dimensions											安装 螺栓 尺寸 Boit	重量 Weight (Kg)
						A	B	H	AB	BB	HA	HD	L	CB	K			
YZO-2-6	970	2	0.12	0.65	1	150	90	90	180	130	12	190	280		14	4*M12	20	
YZO-3-6		3	0.25	0.99	1	180	110	100	225	150	14	220	370		18	4*M16	35	
YZO-5-6		5	0.37	1.37	3	220	140	120	270	200	16	250	465		22	4*M20	60	
YZO-6-6		6	0.40	1.53	3	220	140	120	270	200	16	250	465		22	4*M20	63	
YZO-8-6		8	0.55	2.11	3	220	140	120	270	200	16	250	465		22	4*M20	70	
YZO-10-6		10	0.75	2.47	3	260	150	140	320	220	20	300	520		26	4*M24	80	
YZO-13-6		13	0.65	2.85	3	260	150	140	320	220	20	300	520		26	4*M24	85	
YZO-16-6		16	1.10	3.37	3	260	150	140	320	220	20	300	520		26	4*M24	95	
YZO-20-6		20	1.50	4.47	4	310	170	160	380	240	20	330	630		33	4*M30	135	
YZO-26-6		26	1.85	5.58	4	310	170	160	380	240	20	330	630		33	4*M30	175	
YZO-30-6		30	2.20	6.22	4	350	220	180	430	310	30	400	660		39	4*M36	230	
YZO-40-6		40	3.00	8.38	4	350	220	180	430	310	30	400	660		39	4*M36	255	
YZO-50-6		50	3.70	9.37	4	380	250	215	470	400	35	460	710		45	4*M42	300	
YZO-63-6		63	4.50	11.50	4	380	250	215	470	400	35	460	710		45	4*M42	320	
YZO-80-6A		80	5.50	14.20	5	440	280	240	550	400	40	520	780		45	4*M42	500	
YZO-80-6		80	5.50	14.20	4	440	280	240	510	400	40	520	720		45	4*M42	385	
YZO-100-6A		100	6.30	15.58	6	540	340	260	640	690	40	590	890	130	39	8*M36	665	
YZO-100-6		100	6.30	15.58	7	460	140	250	550	400	40	490	810	140	45	6*M42	430	
YZO-130-6A		130	7.50	18.08	6	540	340	260	640	690	40	590	920	130	39	8*M36	710	
YZO-130-6		130	7.50	18.08	7	460	140	250	550	400	40	490	810	140	45	6*M42	600	
YZO-140-6A		140	9.00	21.83	6	540	340	260	640	690	40	590	950	130	39	8*M36	750	
YZO-150-6A		150	10.00	23.83	6	540	340	260	640	690	40	590	1150	130	39	8*M36	780	
YZO-150-6		150	10.00	23.83	8	520	118	250	610	500	42	500	940	118	39	8*M36	750	
YZO-160-6A		160	12.00	28.6	6	540	340	260	640	690	40	590	1150	130	39	8*M36	800	
YZO-160-6		160	12.00	28.6	8	460	140	250	550	400	40	490	810	140	45	8*M42	625	
YZO-180-6A		180	14.00	33.36	7	540	340	260	640	690	40	590	1150	130	39	8*M36	850	
YZO-180-6B		180	14.00	33.36	8	600	120	270	690	510	45	550	980	120	45	8*M42	890	
YZO-180-6C		180	14.00	33.36	8	520	120	270	610	510	45	550	1000	120	39	8*M36	850	
YZO-210-6		210	16.00	36.93	8	600	120	270	690	510	45	550	1040	120	45	8*M42	950	
YZO-250-6A		250	18.00	43.39	6	630	420	300	740	840	48	680	1170	160	45	8*M42	1250	
YZO-300-6A	300	22.00	52.96	6	630	420	300	740	840	48	680	1210	160	45	8*M42	1360		



图5 NO.5

图6 NO.6

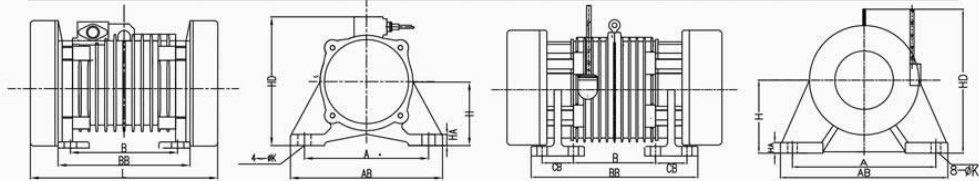

图7 NO.7

图8 NO.8

技术参数及安装尺寸

Technical Date and Installation Size

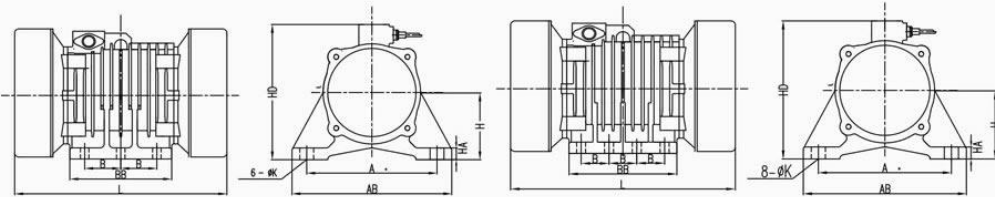
型号 Type	振次/分 ibration Number	额定 激振力 Vibration force(KN)	额定 功率 Power (kW))	额定 电流 Current (A)	外型图 代号 Picture NO.	安 装 尺 寸 Installation dimen										安装 螺栓 Boit	重量 (Kg)
						A	B	H	AB	BB	HA	HD	L	CB	K		
YZO-3-8	720	3	0.25	0.99	3	220	140	120	270	200	16	250	465		22	4*M20	60
YZO-5-8		5	0.37	1.37	3	260	150	140	320	220	20	300	520		26	4*M24	80
YZO-10-8		10	0.75	2.79	4	310	170	160	380	240	20	330	630		33	4*M30	135
YZO-20-8		20	1.50	4.93	4	350	220	180	430	310	30	400	660		39	4*M36	230
YZO-30-8		30	2.20	6.72	4	380	250	215	470	400	35	460	710		45	4*M42	300
YZO-40-8		40	3.00	7.56	4	380	250	215	470	400	35	460	710		45	4*M42	300
YZO-50-8A		50	3.70	9.77	5	440	280	240	550	400	40	520	780		45	4*M42	500
YZO-50-8		50	3.70	9.77	4	440	280	240	520	400	40	520	780		45	4*M42	365
YZO-63-8A		63	4.50	11.95	5	440	280	240	550	400	40	520	780		45	4*M42	525
YZO-63-8		63	4.50	11.95	4	440	280	240	520	400	40	520	780		45	4*M42	390
YZO-80-8A		80	5.50	14.15	6	540	340	260	640	690	40	590	890	130	39	8*M36	665
YZO-80-8		80	5.50	14.15	7	460	140	250	550	400	40	490	810	130	45	6*M42	480
YZO-100-8A		100	6.30	18.55	6	540	340	260	640	690	40	590	890	130	39	8*M36	700
YZO-100-8		100	6.30	18.55	7	460	140	250	550	400	40	490	810	130	45	6*M42	625
YZO-130-8A		130	7.50	21.83	6	540	340	260	640	690	40	590	920	130	39	8*M36	735
YZO-140-8A		140	9.00	24.44	6	540	340	260	640	690	40	590	950	130	39	8*M36	750
YZO-160-8		160	12.00	31.26	8	600	120	270	690	510	45	550	1040	120	45	8*M42	935
YZO-190-8A		250	18.00	38.56	6	630	420	300	740	840	48	680	1170	160	45	8*M42	1350
YZO-250-8A		300	22.00	51.33	6	630	420	300	740	840	48	680	1210	160	45	8*M42	1420



YZO-20-6



YZO-20-4

上海强振电机设备有限公司
SHANGHAI QIANGZHEN MOTOR EQUIPMENTS CO., LTD.



YZO-100-2

人造石英石压机专用振动电机

特种振动电机在人造石英石压机中的应用

Special vibration motors in the use of artificial quartz stone presses



特种振动电机在人造石英石压机中的技术参数及安装尺寸

Special vibration montors in the Technical Date and Installation Size of artificial quartz stone presses

型号 Type	振次/分 Vibration Number	额定 激振力 Vibration force(KN)	额定 功率 Power (kW)	额定 电 流 Current (A)	外型图 代号 Picture NO.	安 装 尺 寸 Installation dimensions										安装 螺栓 尺寸 Boit	重量 Weight (Kg)
						A	B	H	AB	BB	HA	HD	L	K			
YZO-20-2A	2900	20	2.00	4.5	1	260	150	140	320	220	18	300	430	26	4*M24	75	
YZO-20-2B		20	2.00	4.5	1	230	150	140	290	220	18	300	430	26	4*M24	70	
YZO-25-2A		25	2.50	4.85	1	260	150	140	320	220	18	300	430	26	4*M24	80	
YZO-25-2B		25	2.50	4.85	1	230	150	140	290	220	18	300	430	26	4*M24	75	
YZO-30-2A		30	3.00	5.12	2	310	170	160	380	240	20	330	470	33	4*M30	110	
YZO-30-2B		30	3.00	5.12	2	270	170	160	320	240	20	330	470	29	4*M27	105	
YZO-40-2A		40	3.70	6.85	2	310	170	160	380	240	20	330	470	33	4*M30	115	
YZO-40-2B		40	3.70	6.85	2	270	170	160	320	240	20	330	470	29	4*M27	110	
YZO-50-2A		50	4.50	8.43	2	350	220	180	430	310	30	400	520	39	4*M36	180	
YZO-50-2B		50	4.50	8.43	3	320	220	180	370	310	30	400	520	29	6*M27	175	
YZO-63-2A		63	5.50	10.58	2	350	220	180	430	310	30	400	520	39	4*M36	190	
YZO-63-2B		63	5.50	10.58	3	320	220	180	370	310	30	400	520	29	6*M27	185	
YZO-80-2A		80	7.50	13.88	2	380	250	215	470	400	35	460	595	45	4*M42	260	
YZO-80-2B		80	7.50	13.88	3	360	120	215	430	370	35	415	595	29	6*M27	255	
YZO-90-2A		90	9.00	15.90	2	380	250	215	470	400	35	460	595	45	4*M42	275	
YZO-90-2B		90	9.00	15.90	3	360	120	215	430	370	35	415	595	29	6*M27	265	
YZO-100-2A		100	10.00	18.02	2	380	250	215	470	400	35	460	595	45	4*M42	280	
YZO-100-2B		100	10.00	18.02	3	360	120	215	430	370	35	415	595	29	6*M27	275	
YZO-130-2		130	12.00	22.65	2	440	280	240	520	400	40	520	645	45	4*M42	380	



图1 NO.1



图2 NO.2

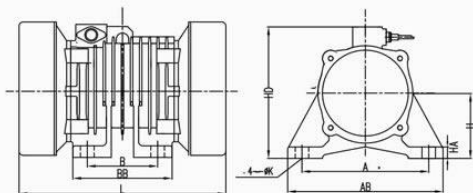

图3 NO.3

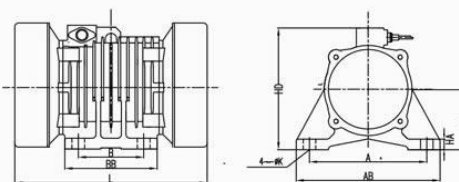

图4 NO.4

派生系列振动电机

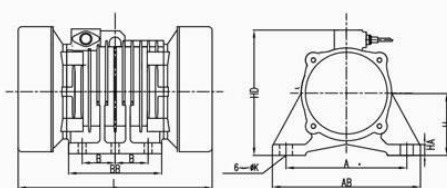

强 振

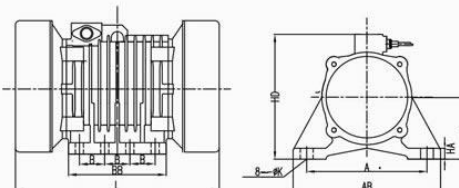
COMPLEMENTARY SERIES VIBRATOR MOTOR

YZL 立式振动电机 Series YZL vertical type vibrator motor

本系列振动电机由立式电机和激振机构组成，所产生的回旋激振力通过电机圆锥面传递给振动机械，使振动机械产生平旋型圆振动和空间摇晃振动的复合工况，可作为各种振动筛、振动磨机、振动光节处理机、振动混料机、平旋型或复旋型振动机械的激振源。

The series vibrator motor is composed of vertical motor and vibrator mechanism, the circular vibration force produced by the motor delivers to vibrator machine by upper and lower foot coning plane of the motor. So the vibrator machine produces composite movement of plane circular vibration and space sway vibration. Therefore, this series vibrator motor can supply vibrator source for the plane rotation or composite rotation machine, such as vibrator sizer, vibrator grinder, vibrator polishing machine, vibrator mixing machine, etc.

技术数据 Technical data

型号	功率 (kW)	极数	电压 (V)	电流 (A)	频率 (Hz)	转速 (r/min)	激振力 (Vibration force (N))		安装尺寸 (Installation dimensions)									
							上	下	D	D ₁	D ₂	D ₃	L	K-θ	α	A	B	C
YZL-1.5	1.5	4	380	3.7	50	1450	6080	12160	360	320	286	278	522-618	6-θ2130°	25	6	32	
YZL-2.2	2.2	4	380	5.2	50	1450	12436	19526	360	320	286	278	522-618	6-θ2130°	25	6	32	
YZL-3.7	3.7	4	380	8.7	50	1450	14715	24525	508	440	440	340	638	8-θ2530°	27	7	35	
YZL-5.0	5.0	4	380	10.5	50	1450	16620	26525	508	440	440	340	683	8-θ2530°	27	7	35	
YZL-5.5	5.5	4	380	11.3	50	1450	17658	37278	508	440	440	340	683	8-θ2530°	27	7	35	
YZL-11	11	4	380	22	50	1450	34335	63765	590	495	426	425	935	8-θ3230°	27	15	55	

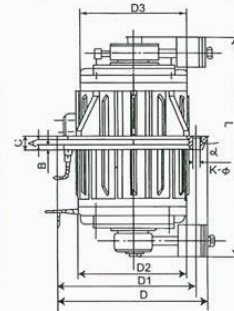

YZFD 调速型振动电机 Series YZFD speed adjustment type vibrator motor

本系列振动电机采用新型的转子结构形式，其转子阻抗具有压敏和频敏特性，在额定电压时阻抗较小，以额定转速运转，产生额定激振力和激振频率，具有较高的效率；电压调低后阻抗变大，可在调压调速过程中得到较大的速度变化范围，满足需要在激振力和振动速度可调工况下运行的振动机械配套要求，可作为各种调速型振动机械的激振源。

本系列振动电机的额定激振力、功率和安装尺寸等技术数据参照YZO系列普通型振动电机的技术数据，其调速范围为100%nN-50%nN。

The series vibrator motor has a new form of composite-rotor its effective rotor impedance has a characteristic of voltage sensitivity and frequency sensitivity. At rated voltage, its impedance is lower, and operates at rated speed, produces rated vibrator force and rated vibrator frequency, has high efficiency. At lower voltage, its impedance increases, there is a wide speed change when regulating the apply voltage. So it can meet the vibrator machine which vibrator force and vibrator frequency required to be regulated, supplies vibrator source for the vibrator machine which speed required to be controlled.

The technical datas of this series vibrator motor such as rated vibrator force, power and installation dimensions, etc. refer to these of series YZO vibrator motor, the speed range is 100%n-50%n.

YFB系列低噪声振动防闭塞装置

Series YFB low noise vibrating block-proof device

YFB系列防闭塞装置是采用最新设计的YZO系列振动电机为激振源的通用型防闭塞装置。

本系列低噪声振动防闭塞装置用于防止和消除料仓、料罐或料斗内物料的起拱、管状通道、粘仓等闭塞现象的专用设备，以保证物料流通，提高物料输送自动化程度，可广泛应用于电力、建材、煤炭、矿山、冶金、食品、化工、轻工、铸造行业。

Series YFB block-proof device is general type block-proof device, it adopts series YZO. Vibrator motor of the latest design for vibration source

The series YFB low noise vibrating block-proof device is special equipment for preventing and cancelling material cambering, forming tubular canal and adhering in the stock-bin or hopper. This device can guarantee the material flowing well and increase the automation of material transferring. It is widely used in various industries, such as power, constructional material, coal, mine, metallurgy, food, chemistry, light industry and foundry, etc.

YFB系列振动防闭塞装置的型号表示方法 THE MEANING OF TYPE

例：FOR EXAMPIE

YFB — 3

振动电源为激振源的低噪声防闭塞装置
LOW NOISE VIBRATING BLOCK-PROOF DEVICE

料斗溜槽壁厚（毫米）
WALL THICK OF HOPPER CHUTE(mm)

技术参数

型号 Type	料仓溜槽 壁厚 Wall thick of hopper or chute (mm)	锥部仓容 Cone capacity of hoppeer (T)	配用振动电动机 matched vibrator motor				外形尺寸 overall dimensions	
			型号 Type	激振力 Vibrating torce (N)	功 率 Power (kW)	质 量 Weight (Kg)	长X宽 LxC (mm)	角钢尺寸 Angle seel dimensions (mm)
YFB-3	2.3-3.2	0.5	YZO-1-2	1000	0.09	10	600×120	30×30×3
YFB-4	3.2-4.5	1	YZO-2-2	2000	0.18	15	800×184	40×40×5
YFB-5	4.5-6	3	YZO-3-2	3000	0.25	20	900×220	50×50×6
YFB-6	6-8	10	YZO-5-2	5000	0.37	26	1000×280	63×63×6
YFB-9	8-12	20	YZO-10-2	10000	0.75	45	1280×285	75×75×10
YFB-12	12-16	50	YZO-20-2	20000	1.5	80	1500×360	100×100×14
YFB-16	16-19	100	YZO-30-2	30000	2.2	120	1500×480	140×140×16

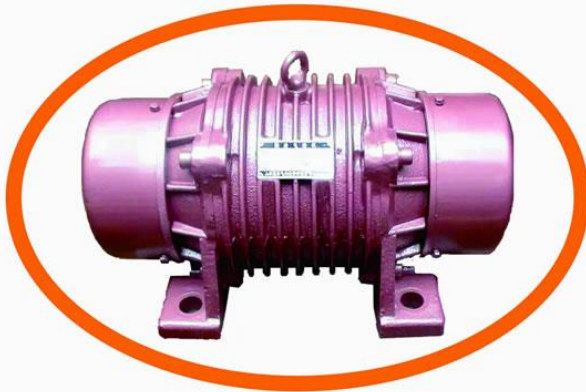

订货须知

- 1、订货时请标明振动电机型号、额定功率、额定激振力、振动次数、安装结构形式等。
- 2、需要派生系列振动电机，有关详细技术参数可来函来人洽谈。
- 3、如有特殊要求，经双方协商，还可供下列特殊要求产品。
 - 1) 特殊电压、频率，如220V，60Hz等。
 - 2) 改变额定功率，额定激振力或安装尺寸等。
 - 3) 带输出轴伸结构。
 - 4) 湿热带型产品。

NOTICE FOR ORDERING

1. When ordering, please specify the type, rated power, rated vibration force, vibration numbers per minutes and installation form.
2. When ordering our complementary series vibrator motor, please negotiate with us about the detailed technical datas.
3. If there is any special requirement, we can supply following special requirement products:
 - (1) Special voltage, frequency such as 220v, 60Hz, etc.
 - (2) Other rated power, rated vibration force or other installation demensions, etc
 - (3) The structure with output shaft extension.
 - (4) Wet tropical products.



上海强振电机设备有限公司
SHANGHAI QIANGZHEN MOTOR EQUIPMENTS CO., LTD.

地址：上海市老真北路121号

手机：13336759395 13120584928

电话：021-52705736

传真：021-52705736

邮编：200062

ADD: 121 LAO ZHEN BEI ROAD SHANGHAI CHINA

MOB: 13336759395 13120584928

TEL: 021-52705736

FAX: 021-52705736

POST: 200062